



# PRESERVATION OF TOMBS OF SULTAN IBRAHIM & AMIR SULTAN MUHAMMAD, WHS MAKLI

## 1<sup>ST</sup> CONSULTATIVE COMMITTEE MEETING

### *Folio II – Introduction to AFCP Project*



# SITE MAP OF MAKLI

## LOCATION OF SULTAN IBRAHIM TOMB

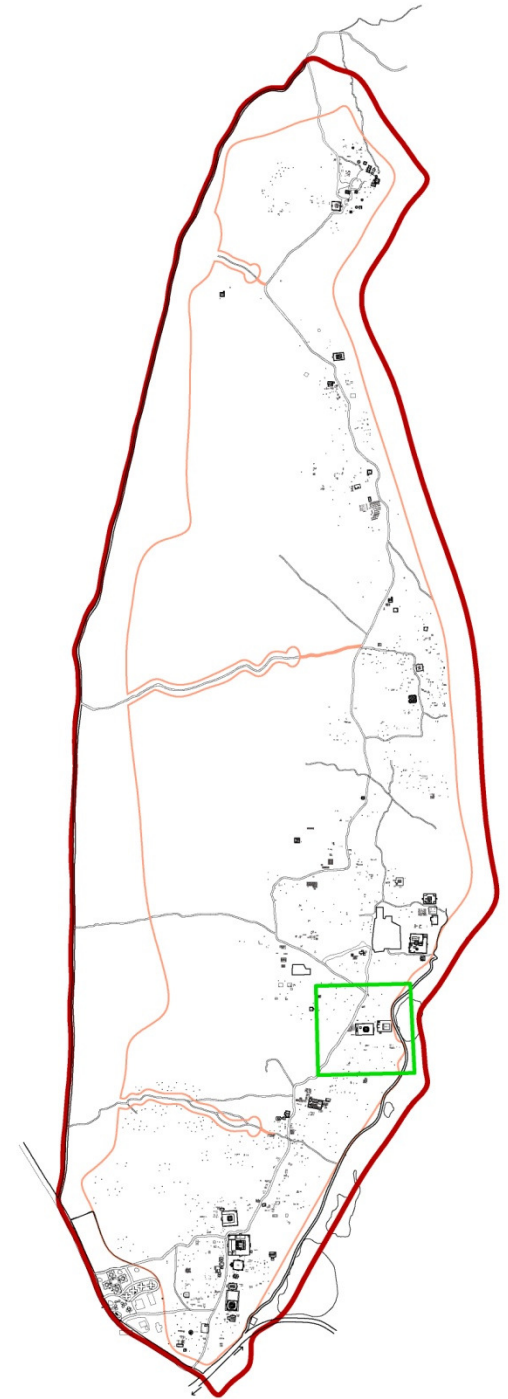
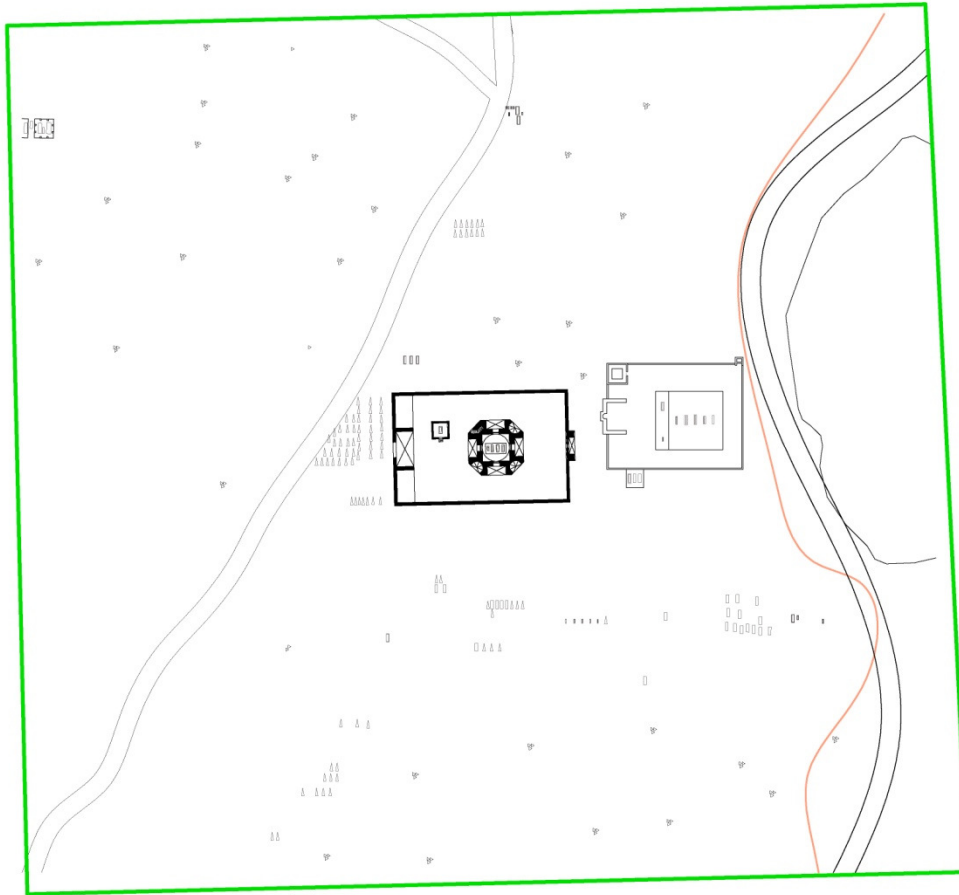



*View from NW*

Notes:  
--

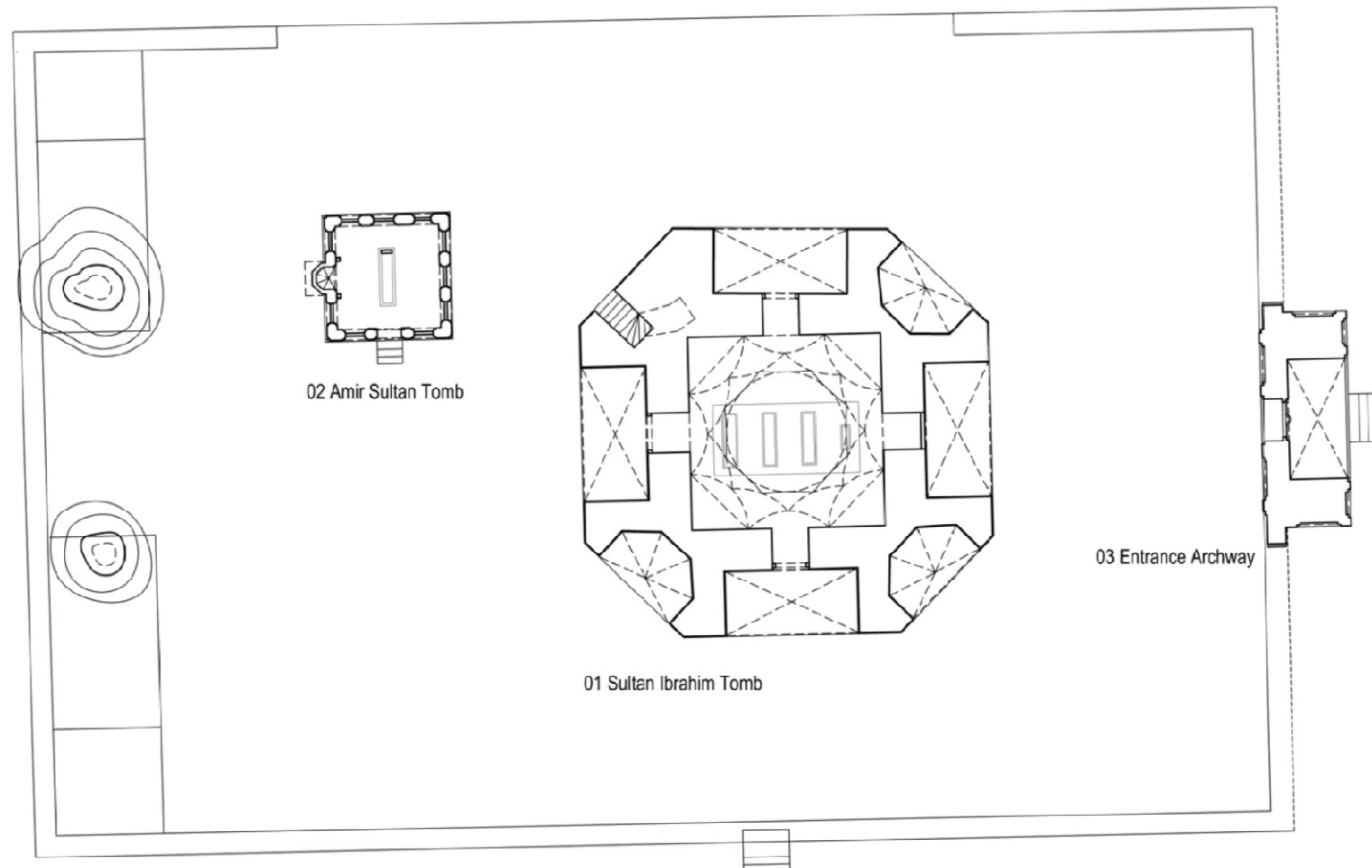

No	Revisions	Date	Sign

Project:

SULTAN IBRAHIM TOMB

Folio:

Architectural Drawings

Title:

Site Plan



Scale:	N	Date:
1:200		Dec. 14
Folio	Category	Element
AD	4/L	(2-)
		Number
		001

*Site Plan*

# PROJECT SCOPE

## PROJECT PERIOD

**15 September 2014 to 14 August 2016**

## PROJECT

### **Conservation Works**

- 1. Tomb of Sultan Ibrahim**
- 2. Tomb of Amir Sultan Mohammad**
- 3. Gateway Arch**
- 4. Treatment of collapsed structure**
- 5. External works; Removal of wild growth, plantation, signage**



# PRESERVATION/CONSERVATION WORKS

## OUTLINE OF PRESERVATION/CONSERVATION WORK

- **Cleaning external and internal brick masonry, glazed tiles, stone masonry, all internal surfaces.**
- **Underpinning of damaged / robbed out brick masonry.**
- **Water tightening by pointing and grouting of open joints and cracks.**
- **Restoration/ repair of dressed stone flooring on platform.**
- **Restoration/conservation of glazed tile (kashi) work carrying Quranic verses, interlacements, geometric and floral patterns.**
- **Restoration of internal stucco and plaster surfaces**
- **Provision of wooden door; closing openings for protection from birds.**
- **Restoration of stone ornamental jali (lattice screen).**
- **Restoration of the broken finial of the tomb.**
- **Restoration of enclosure.**
- **Treatment of collapsed mosque chamber.**
- **Restoration of internal stucco and plaster surfaces.**

# PROJECT TIME LINE

## **Phase I: March 2014 to June 2014**

### **Base Line Information**

- **Setting up Documentation Centre**
- **Geo-technical Study**
- **Structural Evaluation**
- **Condition Survey/Damage Assessment**
- **Physical Survey**
- **Photographic Documentation**
- **Material Testing and Analysis.**

## **Phase II: March 2015 to February 2016**

### **Conservation and Restoration**

- **Structural Stabilization**
- **Brick masonry rehabilitation**
- **Conservation of Decorative Features**
- **Cleaning up and Restoration of External Area.**
- **Plantation**



# PROJECT TIME LINE

## **Training & Capacity Building: November 2014 to Feb. 2016**

### **Field Training of Conservation Personnel**

- **Importance of Monuments**
- **Dry Cleaning & Wet Cleaning**
- **Mortar Treatments for Brick & Stone**
- **Masonry Underpinning**
- **Securing Original Stucco, Kashi**

### **Setting up artisans' workshops**

- **Lime Slaking Procedures**
- **Brick Making & Firing**
- **Glazed Tiles Studio**
- **Stone Carving Studio**

### **Community Outreach**

- **Volunteers**
- **Schools**
- **Women**





[illegible]

## PROJECT DELIVERIES I – SEPTEMBER 2014 TO FEBRUARY 2015

***12<sup>th</sup> September, 2014:*** Signing of Project Agreement between CEO Heritage Foundation of Pakistan and US Embassy Islamabad

***15<sup>th</sup> September, 2014:*** Announcement of Project by HE US Ambassador Richard Olsen and Ms. Sharmila Faruqui, Culture Minister, Gov. of Sindh

***10<sup>th</sup> October, 2014:*** Physical Survey of Building initiated.

***15<sup>th</sup> October, 2014:*** Memorandum of Understanding signed between Department of Culture and Heritage Foundation of Pakistan

***5<sup>th</sup> November, 2014:*** Permission granted by Department of Culture for construction of workshops and artisans' ateliers at WHS Makli

***5<sup>th</sup> November, 2014:*** Structural Studies initiated by Engr. Amin Tariq

***8<sup>th</sup> November, 2014:*** Heritage Façade Cleaning and Mural Painting Activity at Sultan Ibrahim and Amir Sultan Muhammad at WHS Makli.

***10<sup>th</sup> November, 2014:*** Heritage Foundation of Pakistan Teams undertaken parallel studies at tombs.

## PROJECT DELIVERIES II – SEPTEMBER 2014 TO FEBRUARY 2015

***15<sup>th</sup> November, 2014:*** Boreholes by Geotechnical Experts at site by Consolidating Engineering Services.

***5<sup>th</sup> December, 2014:*** Erection and testing of sample Scaffoldings at site.

***30<sup>th</sup> December, 2014:*** Securing doors and ventilator openings with bamboo

***7<sup>th</sup> January, 2015:*** Condition Survey initiated by Ar. Saba Samee. Selection of sand sources, and amples for matching mortars.

***22<sup>nd</sup> January, 2015:*** Material Samples and Testing undertaken for compositions and chemical properties of historic materials.

***30<sup>th</sup> January, 2015:*** Artisans workshops and Studios completed.

***18<sup>th</sup> February, 2015:*** Work on Scientific Dry Cleaning begun after workshop for artisans and HF supervising staff.

***24<sup>th</sup> February, 2015:*** Women's Assembly held for community around WHS Makli by HF staff.

# SWOT ANALYSIS – TOMB OF SULTAN IBRAHIM





# PRESENTATION FOLIOS

***Folio 1:*** Introduction to WH Makli

***Folio 2:*** Introduction to AFCP Project

***Folio 3:*** Significance & Values

***Folio 4:*** Architectural Drawings

***Folio 5:*** Numbering System

***Folio 6:*** Photographic Documentation

***Folio 7:*** Image Superimposition

***Folio 8:*** Historic Brick and Glazed Tiles Analysis

***Folio 9:*** Geotechnical & Structural Consultants' Assessment

***Folio 10:*** Condition Survey, Guiding Notes, Damage Assessment

***Folio 11:*** Material Treatments and Guidelines