

Held on: 26th June, 2014

HF Posters exhibited at the Humanitarian Strategy Workshop in Islamabad, organised by DFID's Humanitarian Advisor, Magnus Wolfe Murray.

**TRAINING. MONITORING. MENTORING.**

COMMUNITY DRIVEN

HERITAGE FOUNDATION OF PAKISTAN SPECIALIZES

DISASTER RISK MITIGATION

PROVIDING

LOW COST

LARGE-SCALE TRAININGS

FLOOD & SEISMIC RESISTANT CONSTRUCTION



SUSTAINABLE, GREEN, BUILD BACK SAFER with Vernacular Methodologies program

SINCE 2012

VILLAGERS CONSTRUCTED OVER **40k** SHELTERS  
HF-TRAINED PROFESSIONALS AS TRAINERS BELONGING TO IOM, HANDS, AGA KHAN HOUSING BOARD, AS WELL AS ARCHITECTS, ENGINEERS, STUDENTS, AND ARTISANS



PREPARING FOR DISASTER with the Community-based Disaster Risk Mitigation program

SINCE 2013

**1200+** WOMEN WERE TRAINED IN GREEN SKILLS & ALTERNATIVE LIVELIHOODS IN PARTNERSHIP WITH IOM, ILO, EMIRATES, SPIRITUAL CHORDS, AND ISLAMIC DEVELOPMENT BANK

**DRR COMPLIANT STOVE KARAVAN PAKOSWISS CHULAH**

PROTECTED FROM THE ELEMENTS

FUEL EFFICIENT USES MINIMAL WOOD

COLLARED DOUBLE STOVES & CHIMNEY

smokeless

EARTHEN RAISED PLATFORM

THE EARTHEN RAISED PLATFORM PROVIDES A PLACE FOR FAMILY ASSEMBLY AS PARENTS DISH OUT FOOD TO CHILDREN

THE FOOD COOKED CAN BE PREPARED HYGIENICALLY SINCE NO DIRT OR FILTH OF THE SURROUNDING AREA CAN REACH THE STOVE OR COOKING SURFACE



INTEGRATED STORAGE protected from FLOODWATER

CLEAN SPACE FOR FAMILY DINING

EASE OF SERVING FOOD

resilient lime & mud construction

SUSTAINABLE, GREEN, VERSATILE



FACEBOOK.COM/HERITAGEFOUNDATIONPAK  
TWITTER.COM/LARIFOUNDATION  
HERITAGEFOUNDATIONPAK.ORG



FACEBOOK.COM/HERITAGEFOUNDATIONPAK  
TWITTER.COM/LARIFOUNDATION  
HERITAGEFOUNDATIONPAK.ORG



Posters by Shay Lari Hosain showing HF initiatives and Karavan PakoSwiss Chulah

**KaravanLatrine**  
DRR-driven Eco-Toilet

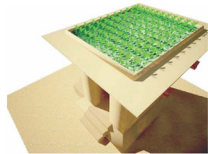

ROOF GARDEN ON STRONG ROOF

HANDWASHING ARRANGEMENT

NIGHT SOIL COLLECTED FOR COMPOST - HOUSEHOLD EARNS RS. 650/MONTH

**KaravanGhar**  
DRR-compliant One Room Shelter

Build Back Safer with Vernacular Methodologies

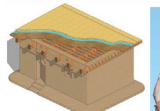

STRONG MULTIPLE BAMBOO KARAVAN ROOF AS SAFE HAVEN

ROOF ANCHORED IN LIME-CONCRETE RING BEAM

SUNDRIED BRICK WALL PROTECTED BY ROOF EAVES

LIME STABILIZED MUD BASE TO PROTECT EARTH WALL FROM SEEPAGE

LIME PLASTER RENDERING FOR WEATHER RESISTANCE



Typical One Room Shelter (ORS) KaravanGhar (Karavan House)



FACEBOOK.COM/HERITAGEFOUNDATIONPAK  
TWITTER.COM/LARIFOUNDATION  
HERITAGEFOUNDATIONPAK.ORG



TRANSFORMING LIVES Attaining Lari's 1st Level of Resilience			
DRR-compliant 100 HH Village (\$20,000)			
NO.	ACTIVITY	IMAGE	HF ALLOCATION (RS.)
1	Women-Centred DRR Centres Low-cost, Sustainable Green Construction		300,000
2	Safe Shelter: 100 @ Rs. 5,000 each • Walls by HH • Guidance & roof fixing by VBE, no fee payment by HH • Gift of roof by HF		500,000
3	KaravanLatrine: 50 @ Rs. 6,000 each • Eco-Toilet Walls by HH, guidance & fixing by VBE • Gift of roof & sanitaryware by HF • HH earns Rs. 650/month through sale of nightsoil		300,000
4	Water Pump: 40 @ Rs. 8,000 each • Raised Earthen Platform and plantation bed by HH • 50% cost and guidance fee to VBE by HH • 50% contribution by HF		320,000
5	Karavan Pakoswiss Chulah: 90 Construction by HH by paying guidance fee to VBE		00
6	KaravanTibba: 90 • Lime-mud elevated platforms for storage of grain, water and solar water • Construction by HH by paying guidance fee to VBE		00
7	Karavan ChatBagheecha: 50 • Roof Garden construction by HH by paying guidance fee to VBE		00
8	Raised bed farming: 40 • To avoid flood waters or saline soil areas • Construction by HH by paying guidance fee to VBE		00
9	Animal Enclosures: 12 • Paved flooring and drain for urine collection • Construction by HH by paying guidance fee to VBE • Gift of miscellaneous materials by HF		60,000
11	Plantation of Neem Trees: 36 • Plantation by HH by paying guidance fee to VBE • Gift of neem trees by HF for animal enclosures and courtyards; other trees by VBE at cost		10,000
12	Organic Fertilizer & Herbal Soap • Low cost organic products for hygiene and livelihood • Household pays fee to VBE for getting training		00
13	Literacy: 100% children in school • Making government schools functional • Making up deficits/ Gift of HF's ParhoPakistan (read Pakistan) pre school centres		150,000
14	Village Healthcare • Primary healthcare through village paramedic • Gift of building and first stock of medicines by HF		150,000
15	Miscellaneous Trainings, monitoring & mentoring, contingencies etc.		210,000
TOTAL REQUIREMENT PER HF'S CORE VILLAGE			2,000,000

Legend:  
HH: Household VBE: Village Barefoot Entrepreneur HF: Heritage Foundation of Pakistan



FACEBOOK.COM/HERITAGEFOUNDATIONPAK  
TWITTER.COM/LARIFOUNDATION  
HERITAGEFOUNDATIONPAK.ORG



HF Posters showing Village Matrix, KaravanLatrine and KaravanGhar